

MORGAN PRODUCTS

PNEUMATIC CHEMICAL PUMPS FOR THE GAS AND OIL INDUSTRIES

MODEL 1255DS-TR2-SR2S

AIR ACTUATED POSITIVE DISPLACEMENT PUMP

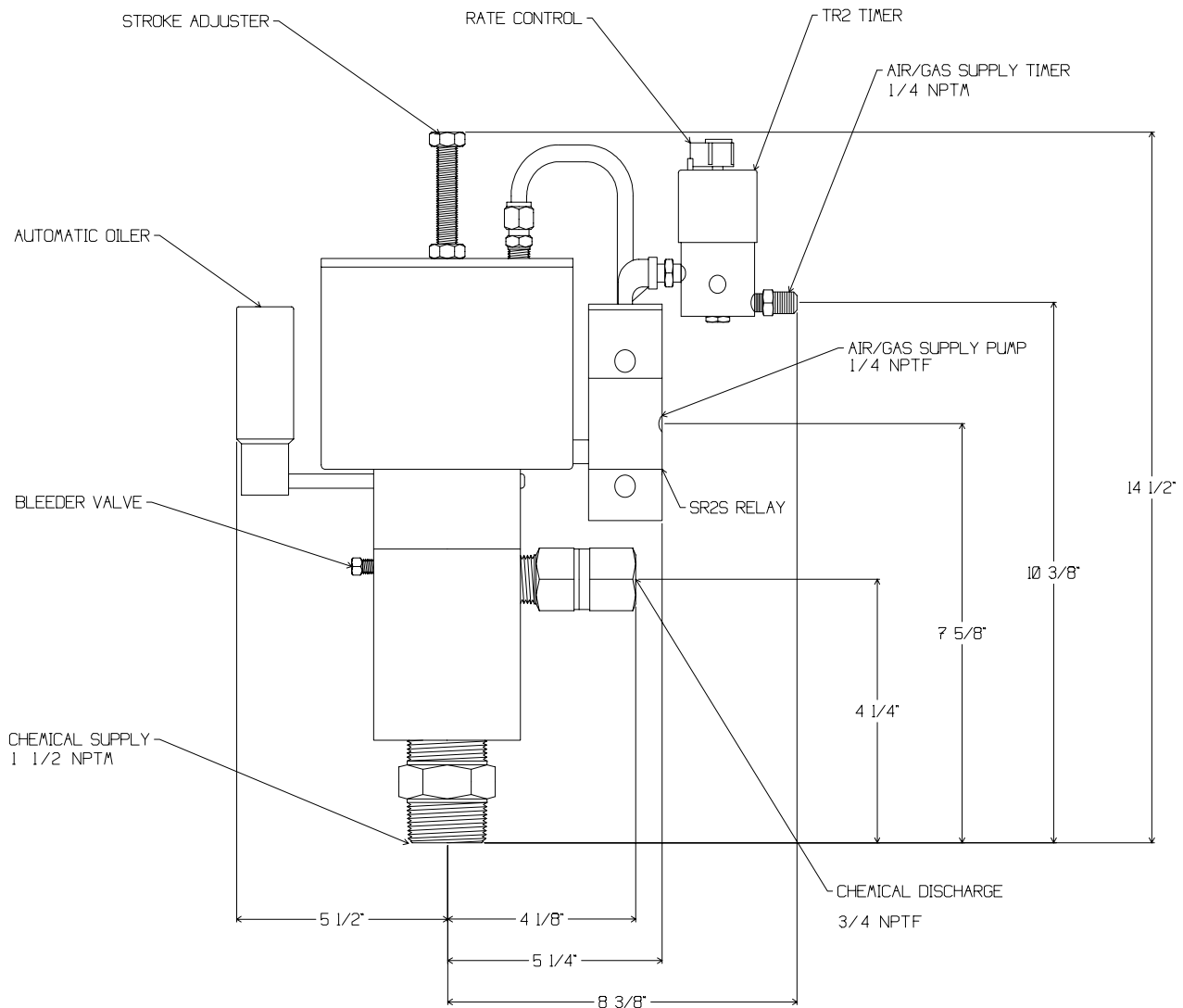

Net Weight 30 Pounds
13.6 Kilograms

| MODEL (WITH TIMER) | DISPLACEMENT | PUMP RATIO | STROKE LENGTH in. - cm. | CONNECTIONS ALL NPT INPUT / OUTPUT | MAXIMUM DISCHARGE PSI - BAR | OUTPUT PER HOUR GAL. / LTS. |
|-----------------------|--------------|---------------|-------------------------------|--|-----------------------------------|-----------------------------------|
| 1255DS-TR2-SR2S | 40.0cc | 14:1 | 2 - 5.10 | 1 1/2 - M / 3/4 - F | 2550-175 | 2.2 - 22 / 8.4 - 84 |

MORGAN PRODUCTS INC. 28103 Ave. Stanford / Valencia, CA 91355

(805) 257-3022 - (800) 421-8910 - FAX (805) 257-3385

www.morganproducts.com - E-Mail info@morganproducts.com

MORGAN PRODUCTS

PNEUMATIC CHEMICAL PUMPS FOR THE GAS AND OIL INDUSTRIES

Parts List Model 1255DS

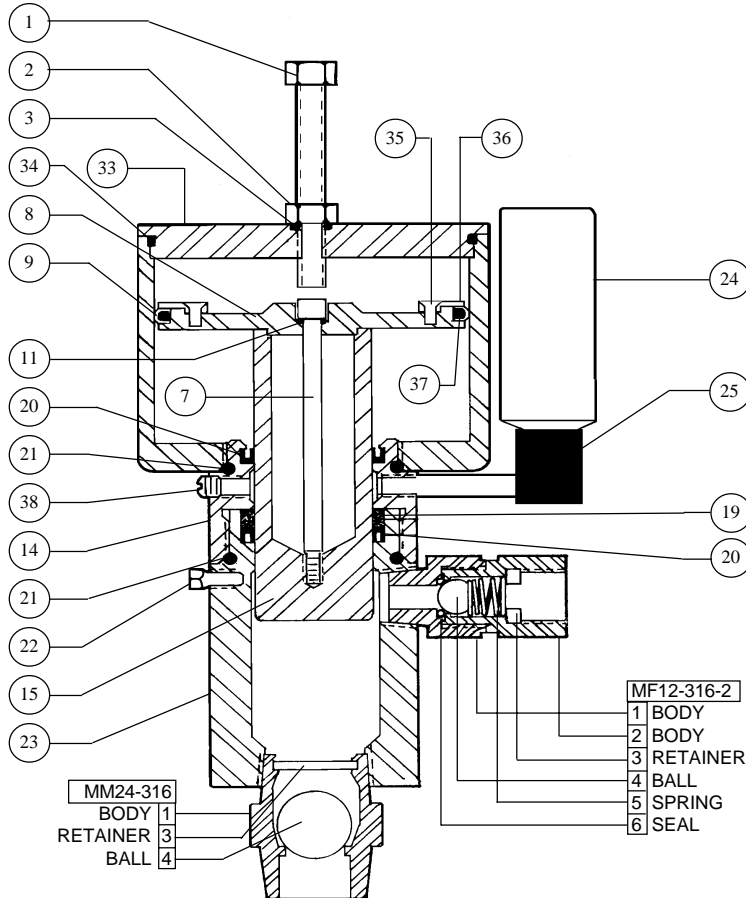

| NO | NAME | PART NO. |
|----|-------------------|---------------|
| 1 | Stroke Adjuster | 5000-1 |
| 2 | Locknut | 3000-2 |
| 3 | O-Ring Seal | 3000-3 * |
| 4 | Air chamber | 1255-4 |
| 7 | Piston Bolt | 5000-7 |
| 8 | Piston | 1255-8 |
| 9 | Piston Seal | 5000-9 * |
| 11 | O-Ring Seal | 100-3 * |
| 14 | Oil Chamber | 1255-14 |
| 15 | Plunger 17-4TN | 1250-15 * |
| | Optional Material | |
| | Plunger 316 SS | 1255-17 |
| 19 | Back-up Ring | 1255-19 * |
| 20 | Pressure Seal | 1255-20 * (2) |
| 21 | Body O-Ring Seal | 1255-21 * (2) |
| 22 | Bleeder | 125-22 |
| 23 | Fluid Chamber | 1255-23 |
| 24 | 4 oz. Oil | 5000-24 * |
| 25 | Reservoir | 3000-25 |
| 27 | Elbow | 5000-27 |
| 32 | Nipple | 3000-32 |
| 33 | Air Chamber Cap | 5000-33 |
| 34 | Cap O-Ring | 5000-34 * |
| 35 | Screw | 5000-35 (8) |
| 36 | Seal Retainer | 5000-36 |
| 37 | Piston O-Ring | 5000-37 * |
| 38 | 1/8 NPT Plug | 5000-38 |
| | 1oz. Grease | * |
| | Repair Kit | |
| | W/ 17-4TN Plunger | 1250-50 |
| | W/ 316 SS Plunger | 1255-50 |

* = Included in Repair Kit

INSTALLATION INSTRUCTIONS

1. Discard all red plastic closures.
2. Connect suction check valve, to a gravity fed chemical.
3. Connect discharge check valve, to process line.
4. Connect a regulated air or gas supply, to the timing relay and SR1S Relay.
5. Fill oil reservoir with oil provided.
6. Open bleeder until chemical flows from bleeder.
7. Set regulator at 10 - 15 psi ABOVE the pressure required. (See discharge pressure graph).
8. Set cycle rate in strokes per minute. (See volume graph).

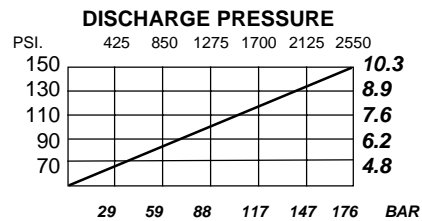
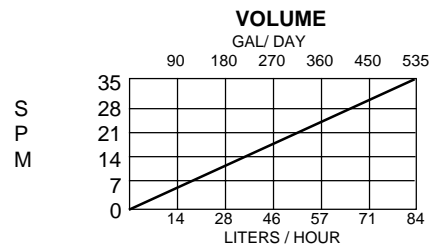

MORGAN PRODUCTS INC. 28103 Ave. Stanford / Valencia, CA 91355

(805) 257-3022 - (800) 421-8910 - FAX (805) 257-3385